

UNITED STATES DEPARTMENT OF THE INTERIOR  
NATIONAL PARK SERVICE

NATIONAL REGISTER OF HISTORIC PLACES  
INVENTORY -- NOMINATION FORM

FOR NPS USE ONLY	
RECEIVED	
DATE ENTERED	

SEE INSTRUCTIONS IN HOW TO COMPLETE NATIONAL REGISTER FORMS  
TYPE ALL ENTRIES -- COMPLETE APPLICABLE SECTIONS

**1 NAME**

HISTORIC

4 HERN'S MILL COVERED BRIDGE

AND/OR COMMON

**2 LOCATION**

STREET & NUMBER

Secondary Route 40 at junction of Route 60/11, crossing Milligan Creek

CITY, TOWN

NOT FOR PUBLICATION

X VICINITY OF Lewisburg

CONGRESSIONAL DISTRICT

STATE

West Virginia

CODE  
54

COUNTY  
Greenbrier

CODE  
025

**3 CLASSIFICATION**

CATEGORY	OWNERSHIP	STATUS	PRESENT USE
<input type="checkbox"/> DISTRICT	<input checked="" type="checkbox"/> PUBLIC	<input checked="" type="checkbox"/> OCCUPIED/in service	<input type="checkbox"/> AGRICULTURE
<input type="checkbox"/> BUILDING(S)	<input type="checkbox"/> PRIVATE	<input type="checkbox"/> UNOCCUPIED	<input type="checkbox"/> MUSEUM
<input checked="" type="checkbox"/> STRUCTURE	<input type="checkbox"/> BOTH	<input type="checkbox"/> WORK IN PROGRESS	<input type="checkbox"/> COMMERCIAL
<input type="checkbox"/> SITE	<input type="checkbox"/> PUBLIC ACQUISITION	<input type="checkbox"/> ACCESSIBLE	<input type="checkbox"/> EDUCATIONAL
<input type="checkbox"/> OBJECT	<input type="checkbox"/> IN PROCESS	<input type="checkbox"/> YES: RESTRICTED	<input type="checkbox"/> ENTERTAINMENT
	<input type="checkbox"/> BEING CONSIDERED	<input checked="" type="checkbox"/> YES: UNRESTRICTED	<input type="checkbox"/> GOVERNMENT
		<input type="checkbox"/> NO	<input type="checkbox"/> INDUSTRIAL
			<input checked="" type="checkbox"/> TRANSPORTATION
			<input type="checkbox"/> MILITARY
			<input type="checkbox"/> OTHER:

**4 OWNER OF PROPERTY**

NAME

West Virginia Department of Highways

STREET & NUMBER

1900 Washington Street, East

CITY, TOWN

Charleston

VICINITY OF

STATE

West Virginia 25305

**5 LOCATION OF LEGAL DESCRIPTION**

COURTHOUSE,  
REGISTRY OF DEEDS, ETC.

Greenbrier County Court House, Office of the County Clerk

STREET & NUMBER

CITY, TOWN

Lewisburg

STATE

West Virginia

**6 REPRESENTATION IN EXISTING SURVEYS**

TITLE

None

DATE

FEDERAL  STATE  COUNTY  LOCAL

DEPOSITORY FOR  
SURVEY RECORDS

CITY, TOWN

STATE

# DESCRIPTION

<b>CONDITION</b>		<b>CHECK ONE</b>	<b>CHECK ONE</b>
<input type="checkbox"/> EXCELLENT	<input type="checkbox"/> DETERIORATED	<input type="checkbox"/> UNALTERED	<input checked="" type="checkbox"/> ORIGINAL SITE
<input type="checkbox"/> GOOD	<input type="checkbox"/> RUINS	<input checked="" type="checkbox"/> ALTERED	<input type="checkbox"/> MOVED DATE _____
<input checked="" type="checkbox"/> FAIR	<input type="checkbox"/> UNEXPOSED		

DESCRIBE THE PRESENT AND ORIGINAL (IF KNOWN) PHYSICAL APPEARANCE

The Hems Mill Covered Bridge has red board-and-batten siding and a roof made of galvanized metal sheeting. It has a span of 53 feet-8 inches and a width of 10 feet-6 inches.

The truss design is a local variation of the queen post type, in which the 8 x 11 inch diagonals fit into the ends of the huge 11 x 18 inch bottom chord. The vertical posts divide the truss into six panels, which are 9 feet-5 inches high. The cross sectional dimensions of the two large centerposts and the other five posts are 9 x 12 inches and 6 x 6 inches, respectively. Double metal tension rods, that run along the sides of the large centerposts are bolted to the bottom chord, top chord and diagonal.

In recent times the bridge has been heavily reinforced. Wide flange stringers provide a majority of the support for the asphalt riding surface (which was originally a timber deck) and a concrete pier and steel bent support the bridge at midspan.

# 18 SIGNIFICANCE

PERIOD		AREAS OF SIGNIFICANCE -- CHECK AND JUSTIFY BELOW			
<input type="checkbox"/> PREHISTORIC	<input type="checkbox"/> ARCHEOLOGY-PREHISTORIC	<input type="checkbox"/> COMMUNITY PLANNING	<input type="checkbox"/> LANDSCAPE ARCHITECTURE	<input type="checkbox"/> RELIGION	
<input type="checkbox"/> 1400-1499	<input type="checkbox"/> ARCHEOLOGY-HISTORIC	<input type="checkbox"/> CONSERVATION	<input type="checkbox"/> LAW	<input type="checkbox"/> SCIENCE	
<input type="checkbox"/> 1500-1599	<input type="checkbox"/> AGRICULTURE	<input type="checkbox"/> ECONOMICS	<input type="checkbox"/> LITERATURE	<input type="checkbox"/> SCULPTURE	
<input type="checkbox"/> 1600-1699	<input type="checkbox"/> ARCHITECTURE	<input type="checkbox"/> EDUCATION	<input type="checkbox"/> MILITARY	<input type="checkbox"/> SOCIAL/HUMANITARIAN	
<input type="checkbox"/> 1700-1799	<input type="checkbox"/> ART	<input checked="" type="checkbox"/> ENGINEERING	<input type="checkbox"/> MUSIC	<input type="checkbox"/> THEATER	
<input checked="" type="checkbox"/> 1800-1899	<input type="checkbox"/> COMMERCE	<input type="checkbox"/> EXPLORATION/SETTLEMENT	<input type="checkbox"/> PHILOSOPHY	<input checked="" type="checkbox"/> TRANSPORTATION	
<input type="checkbox"/> 1900	<input type="checkbox"/> COMMUNICATIONS	<input type="checkbox"/> INDUSTRY	<input type="checkbox"/> POLITICS/GOVERNMENT	<input type="checkbox"/> OTHER (SPECIFY)	
		<input type="checkbox"/> INVENTION			

SPECIFIC DATES 1884

BUILDER/ARCHITECT Unknown

## STATEMENT OF SIGNIFICANCE

The construction of the Hems Mill Covered Bridge was an undertaking of the Greenbrier County Court in 1884. Lewisburg District road commissioners Harvey Handly and J. W. Johnston, who had been ordered in January of the same year to examine the bridge over "Millicans" Creek near the mill of S. S. Hems, made a report to the court concerning the present condition of the bridge and the probable cost of construction of a new bridge at that location. The same day the court ordered the commissioners to take the necessary action to have the bridge rebuilt. Harvey Handly, J. W. Johnston and John D. Arbuckle, commissioners, on July 9, 1884, submitted an order to the court which stated that the bridge had been completed according to the contract. Drafts were then issued to the unnamed contractors for the sum of \$800.00.

The Hems Mill Bridge undoubtedly provided convenient access to the S. S. Hems Mill when it was in operation. Although it does not serve the same purpose today, it is still used by local traffic and visited by tourists driving through the area. The bridge is one of the two remaining covered bridges in Greenbrier County and one of many covered bridges built in the 1800's which exhibited the queenpost truss design that was commonly used for spans of 40 to 50 feet. If proper steps are not soon initiated to upgrade and restore the bridge, it will soon deteriorate beyond repair.



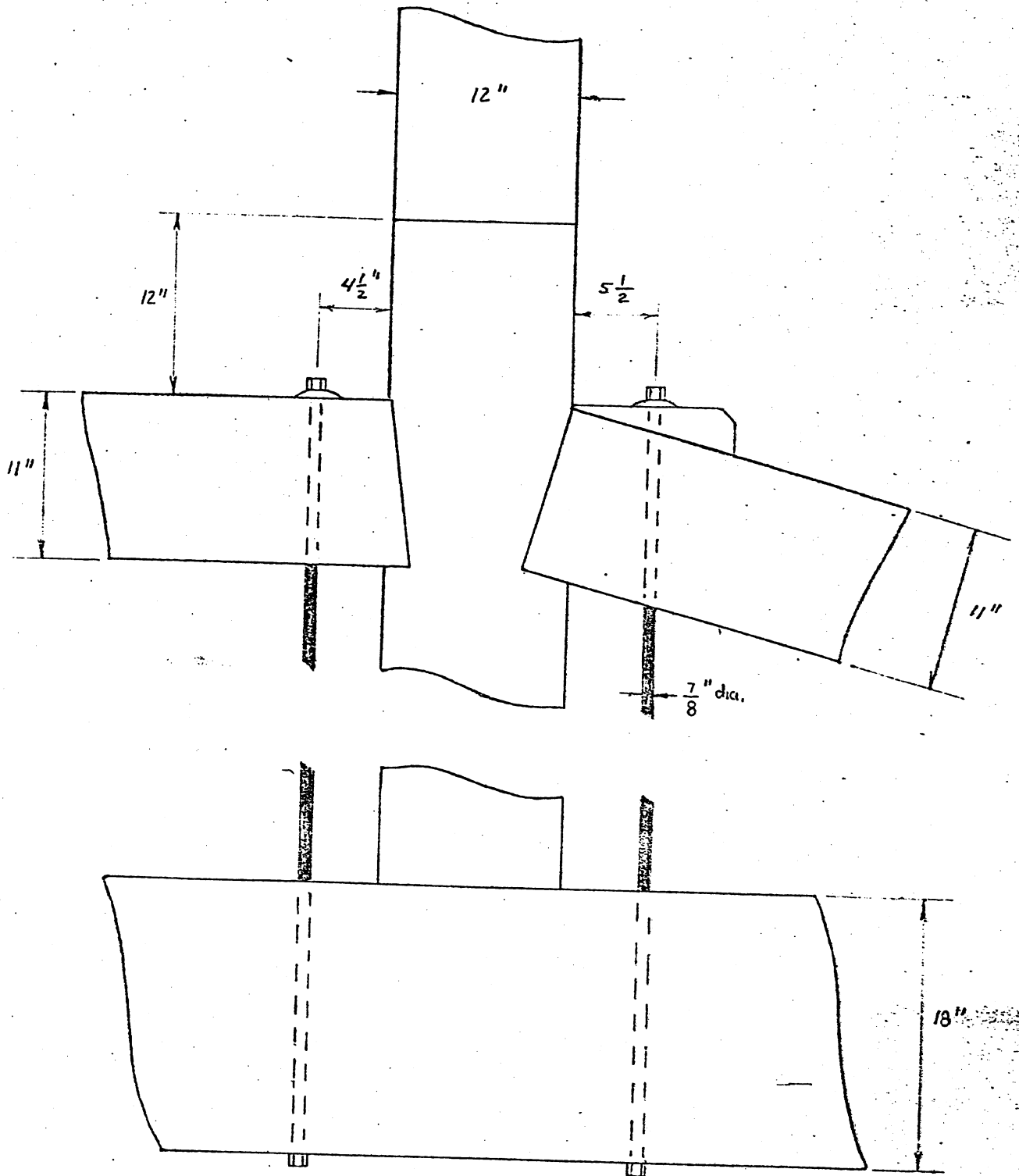

5. HERNS MILL COVERED BRIDGE

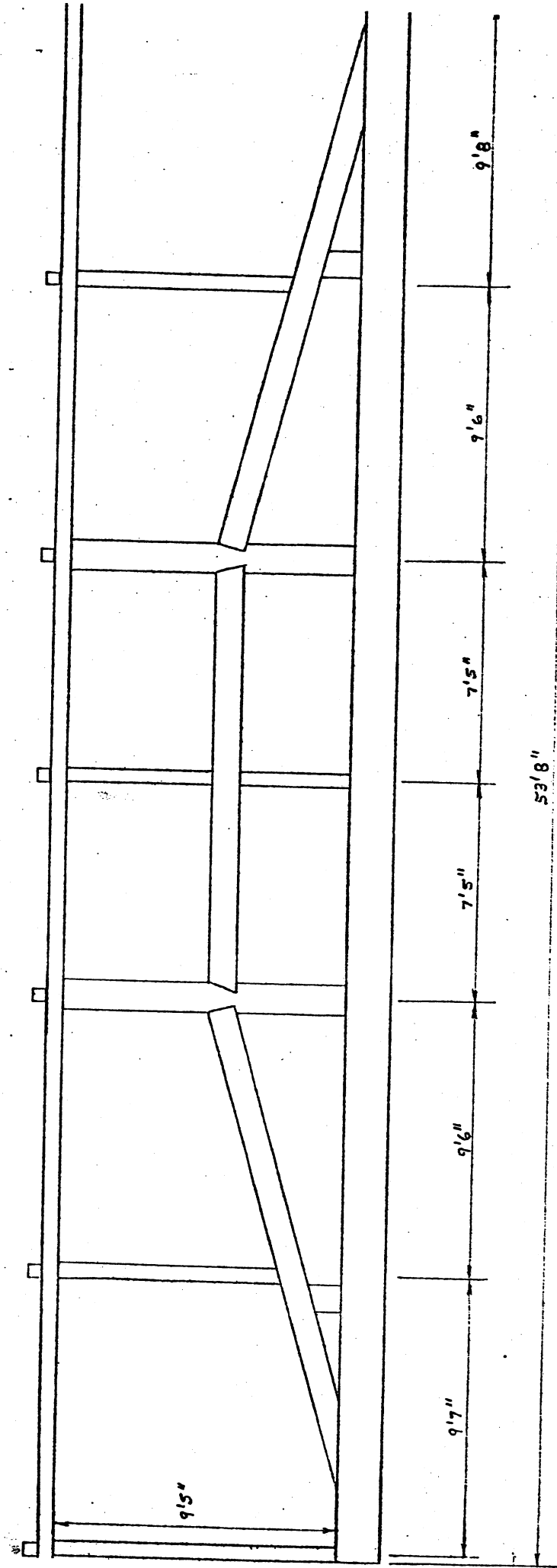

5. HERNS MILL COVERED BRIDGE

STATE OF WEST VIRGINIA  
REPRESENTED BY THE  
STATE OF WEST VIRGINIA GEOLOGICAL SURVEY  
AND OTHER STATE AGENCIES

